

4.5- Installation on CMU walls

2- Typical CMU wall with rigid insulation

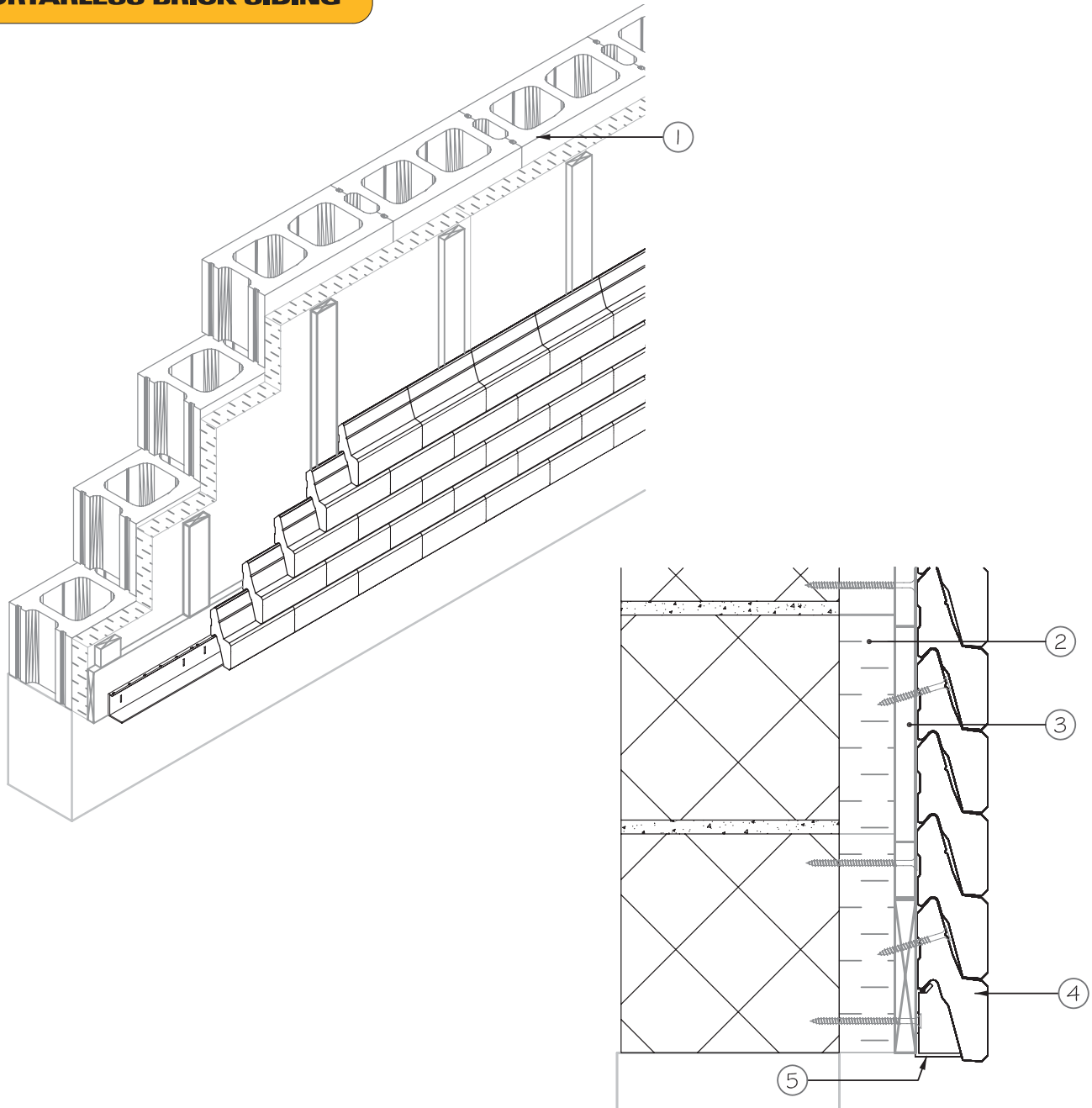

LEGEND:

- 1- Concrete masonry unit (CMU) block wall (by others).
- 2- Rigid insulation, limit insulation thickness to a maximum of 2" (50mm)
- 3- 1" x 3" (19mm x 64mm) wood furring at 16" (406mm) o.c. fastened at 10" (254mm) o.c. with 3/16" x 4" (5mm x 100mm) corrosion resistant concrete screws.
- 4- Novabrik fastened with #10 x 2½" (64mm) wood screws at every fourth course at each furring strip.
- 5- Starter strip fastened with 3/16" x 4" (5mm x 100mm) concrete screws at 10" (254mm) o.c. over 1" x 6" (19mm x 140mm) treated baseboard fastened top and bottom at 8" o.c. with #10 corrosion resistant screws (min. 1¼" (32mm) penetration into structure).

