

4.2- Novabrik Installation

7- Over rigid insulation

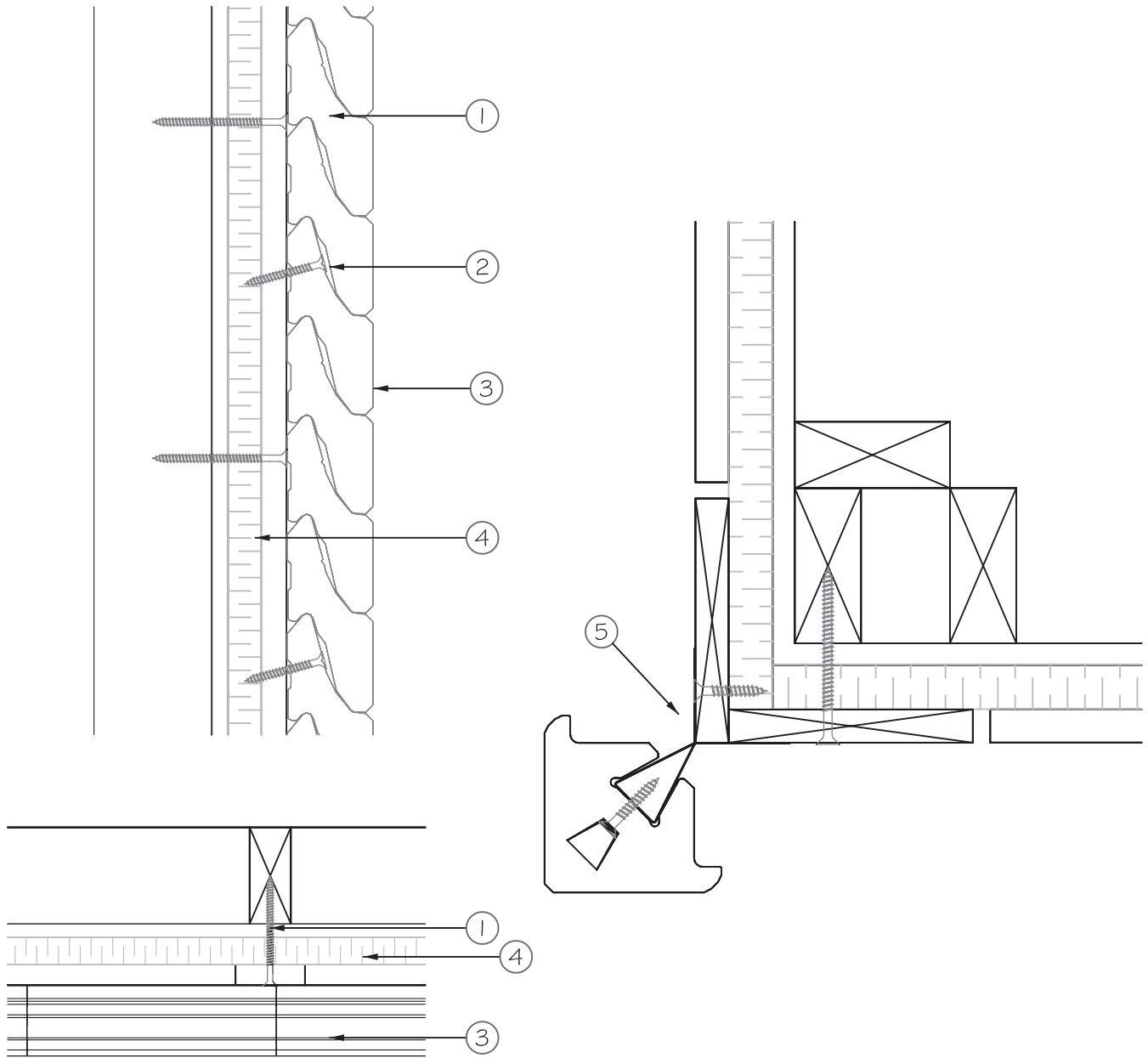

LEGEND:

- 1- Corrosion resistant #10 wood screws at 10" (254mm) o.c. (1¼" (32mm) min. penetration into stud)
- 2- Fasten every fourth row with #10 x 2½" (64mm) corrosion resistant screw at each furring strip.
- 3- Novabrik
- 4- Rigid insulation: limit insulation thickness to a maximum of 2" (50mm)
- 5- Corner block installation (second generation): install 1" x 6" (19mm x 140mm) boards fastened to the studs.

